

BUEIRO SIMPLES TUBULAR DE CONCRETO (BSTC) - Ø 0.60m

PROJETO BÁSICO
SEM ESCALA

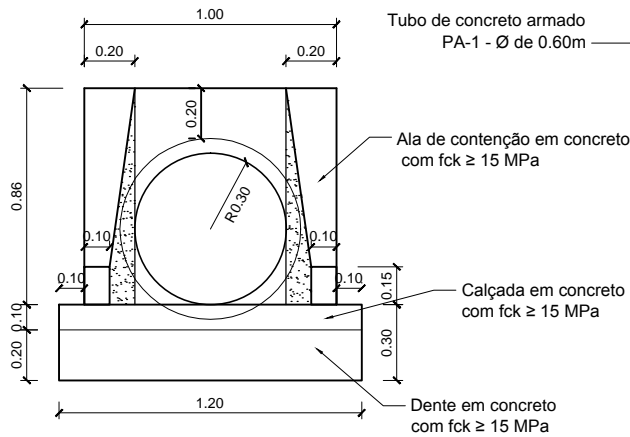

VISTA FRONTAL

Boca de bueiro simples de concreto Ø 0.60m

Ala de contenção em concreto com fck ≥ 15 MPa

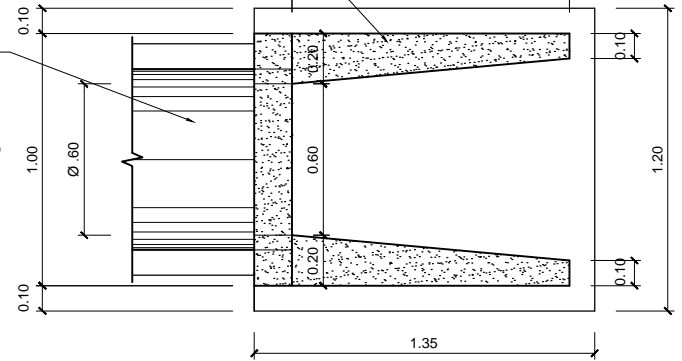

PLANTA BAIXA

Boca de bueiro simples de concreto Ø 0.60m

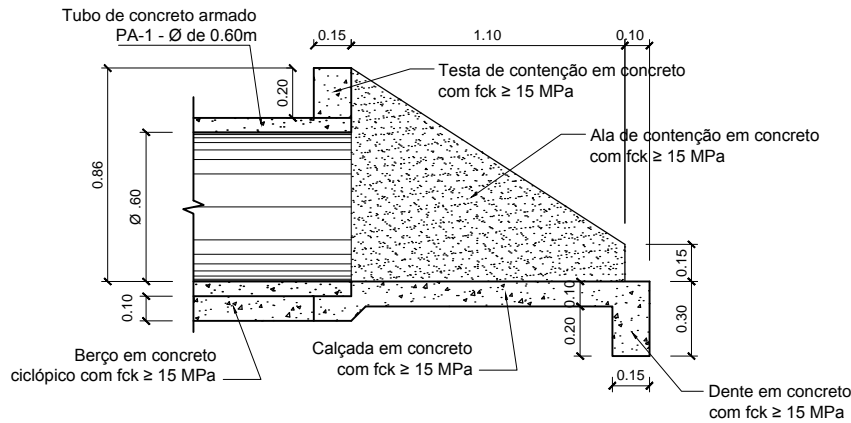

VISTA LATERAL

Boca de bueiro simples de concreto Ø 0.60m

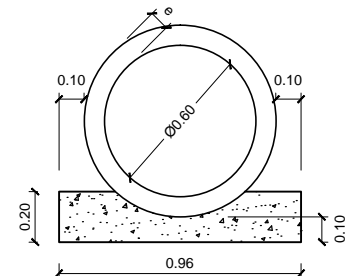

CORTE EM BUEIRO

Berço para bueiro simples de concreto Ø 0.60m

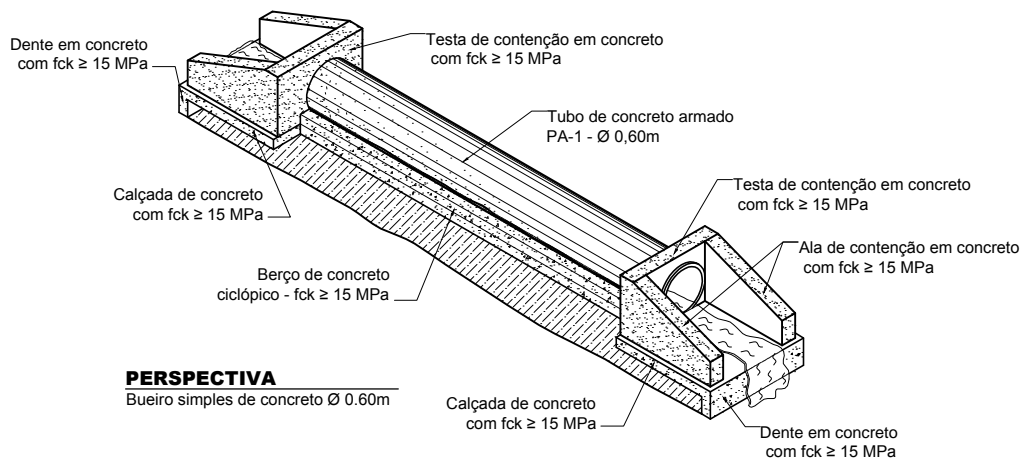

PERSPECTIVA

Bueiro simples de concreto Ø 0.60m



Assunto:

**Detalhamento das Obras
de Arte Correntes**

Responsável Técnico: